















# SAKURA-CON 2011

April 22 - 24

Washington State Convention Center  
800 Convention Place, Seattle, WA 98101

Revised April 11

## Legend

- |   |                                   |   |                                   |
|---|-----------------------------------|---|-----------------------------------|
|  | Event and Panel Rooms             |  | Men's restrooms                   |
|  | Video Theaters                    |  | Women's restrooms                 |
|  | Merchandise and Services          |  | Escalators to level above/below   |
|  | Workshops, Arts and Crafts        |  | Elevators accessible by attendees |
|  | Video Gaming                      |  | Pay phones                        |
|  | Tabletop Gaming                   |  | First Aid Stations (Levels 4 & 6) |
|  | Sakura-Con offices                |   |                                   |
|  | Rooms not accessible by attendees |   |                                   |

## Level 2: Services, Panel Room, Karaoke, Staff Offices

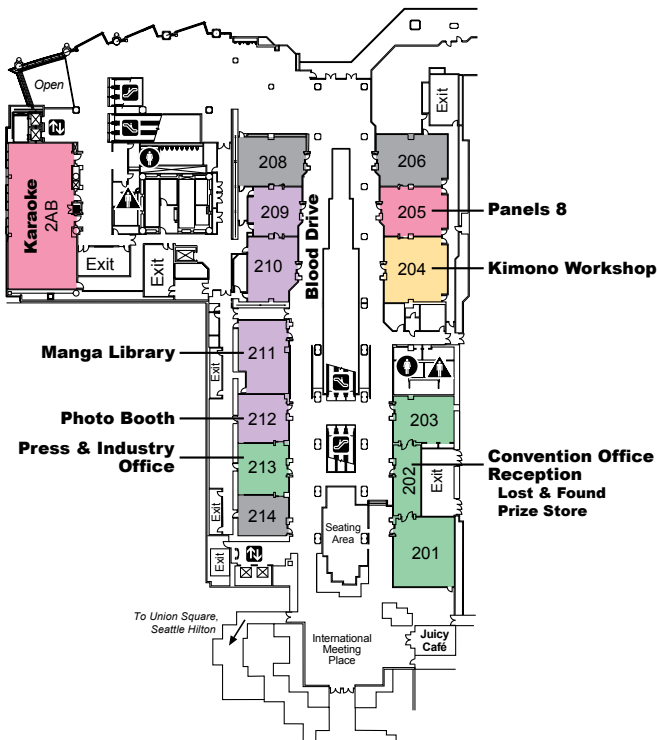

## Level 3: Tabletop Gaming, Video Theater, Arts & Crafts

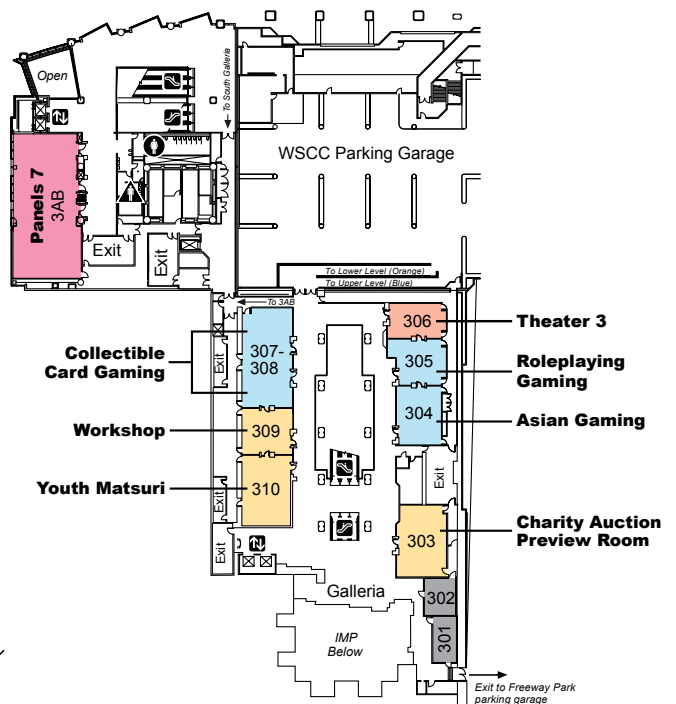



# Level 6: Main Panel Rooms & Video Theaters, Artist Alley

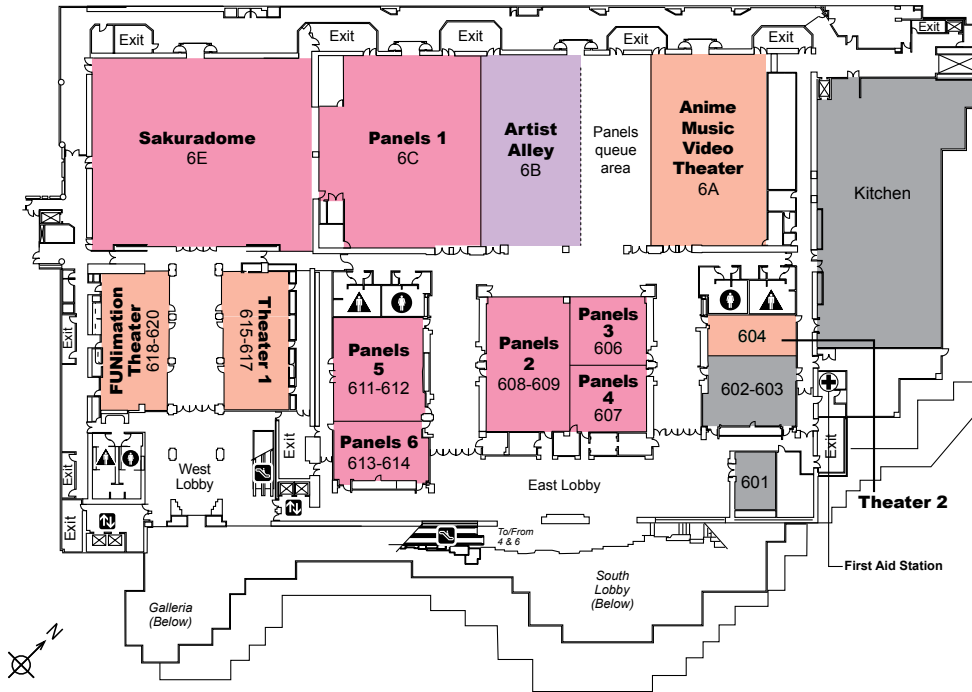

## Street Map: WSTC and Vicinity, Downtown Seattle



The **Downtown Seattle Transit Tunnel** is the first tunnel of its kind in the United States to be used by both buses and light rail simultaneously.

Tunnel hours of operation:  
 Monday - Saturday: 5:00 am - 1:00 am  
 Sunday: 6:00 am - Midnight

### Sound Transit Light Rail to/from Sea-Tac Airport:

Fare: \$2.50 for adults, \$2.00 for ages 6-18, free for 5 and under.  
 Travel time: approx. 37 minutes. The last stop for light rail is the Westlake station; light rail trains do not stop at Convention Place.  
 See [www.soundtransit.org](http://www.soundtransit.org) for complete details.

### Metro Bus Ride-Free Area:

All buses (but *not* light rail) are free to ride from 6:00 am - 7:00 pm daily between any of the stations on the tunnel:

- Convention Place
- Westlake
- University Street
- Pioneer Square
- International District/Chinatown

See [metro.kingcounty.gov](http://metro.kingcounty.gov) for complete details.

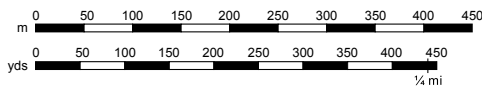

- ← One-way street
- ↔ Two-way traffic begins/ends

