



# SAKURA-CON 2012

**April 6 - 8**

**Washington State Convention Center  
800 Convention Place, Seattle, WA 98101**

## Convention Site Map and Floor Plans

Revised March 15

### Area Map, Downtown Seattle

Note offsite locations for **Registration** and **Pre-Registration**



 Sakura-Con affiliated hotels



The **Downtown Seattle Transit Tunnel** is the first tunnel of its kind in the United States to be used by both buses and light rail simultaneously.

Tunnel hours of operation:

Monday - Saturday: 5:00 am - 1:00 am

Sunday: 6:00 am - Midnight

#### Sound Transit Light Rail to/from Sea-Tac Airport:

Fare: \$2.50 for adults, \$2.00 for ages 6-18, free for 5 and under. Travel time: approx. 37 min.



The last stop for light rail is the Westlake station; light rail trains do not stop at Convention Place. See [www.soundtransit.org](http://www.soundtransit.org) for complete details.

#### Metro Bus Ride-Free Area:

All buses (but *not* light rail) are free to ride from 6:00 am - 7:00 pm daily between any of the stations on the tunnel:

- Convention Place
- Westlake
- University Street
- Pioneer Square
- International District/Chinatown

See [metro.kingcounty.gov](http://metro.kingcounty.gov) for complete details.

 One-way street  
 Two-way traffic begins/ends

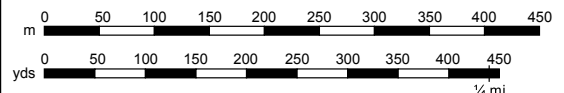

## Registration: Grand Hyatt, Level 1

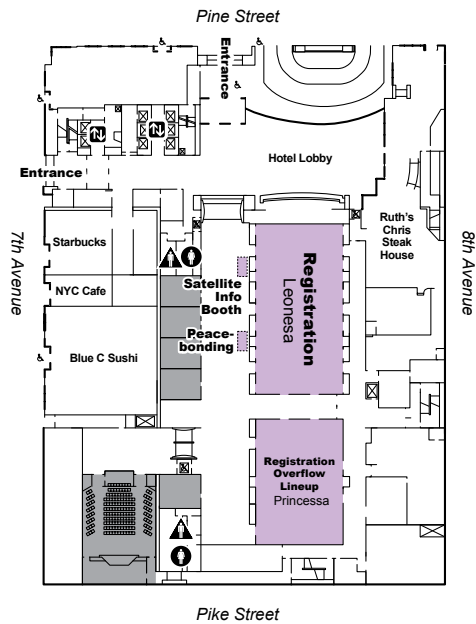

## Pre-Registration: The Conference Center, Level 3

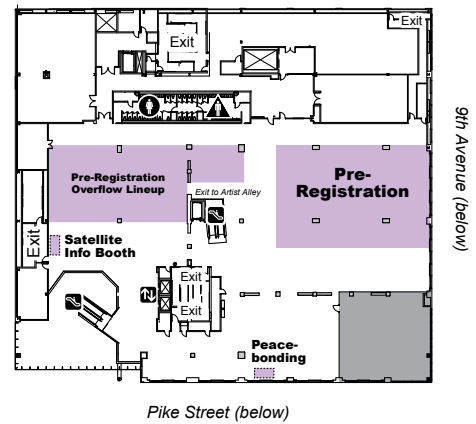

## WSCC Level 2

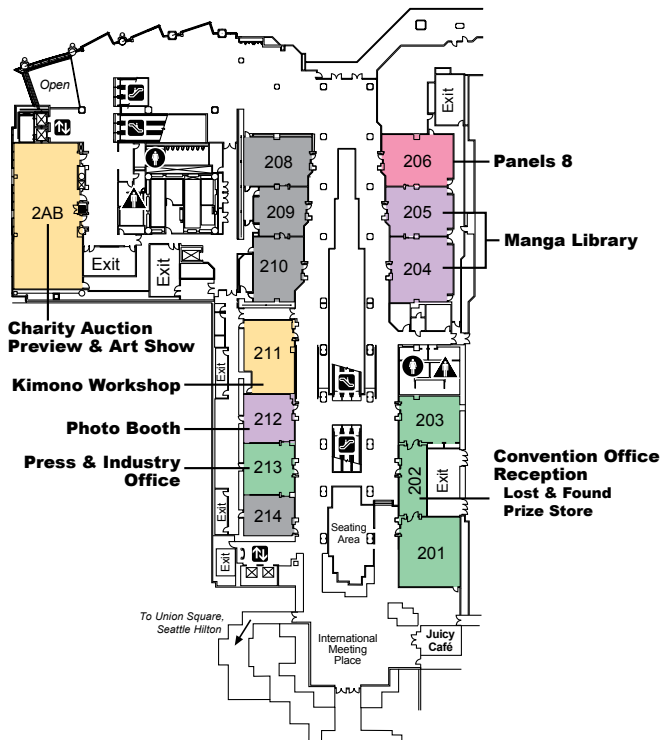

## WSCC Level 3

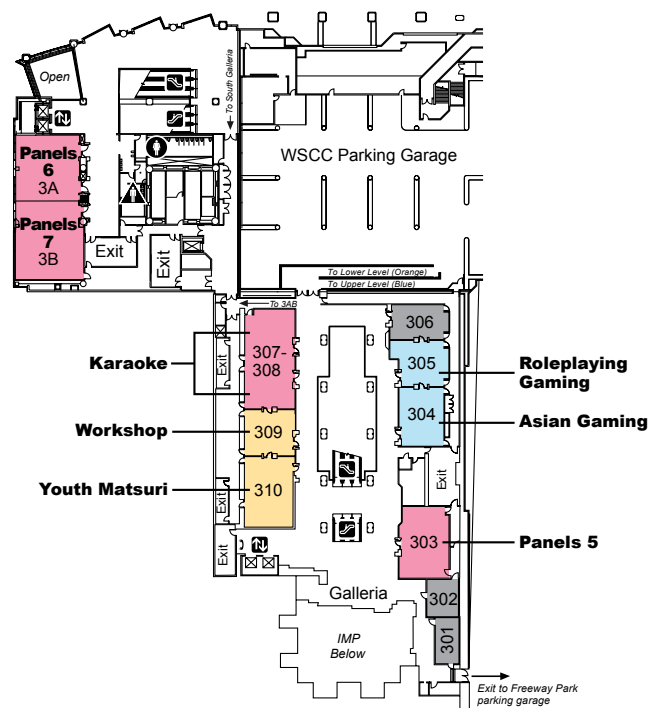

# WSCC Level 4

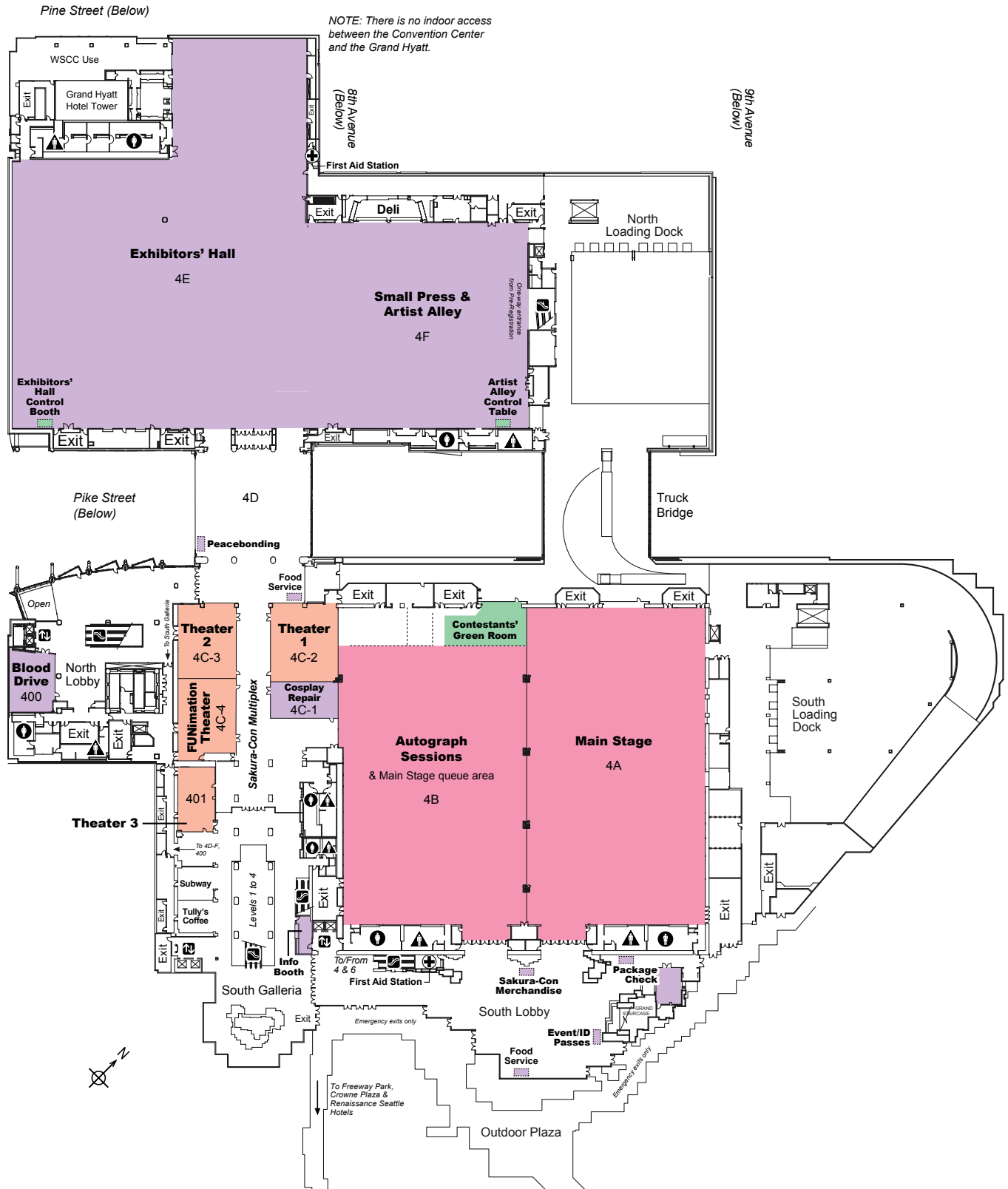

## WSCC Level 6

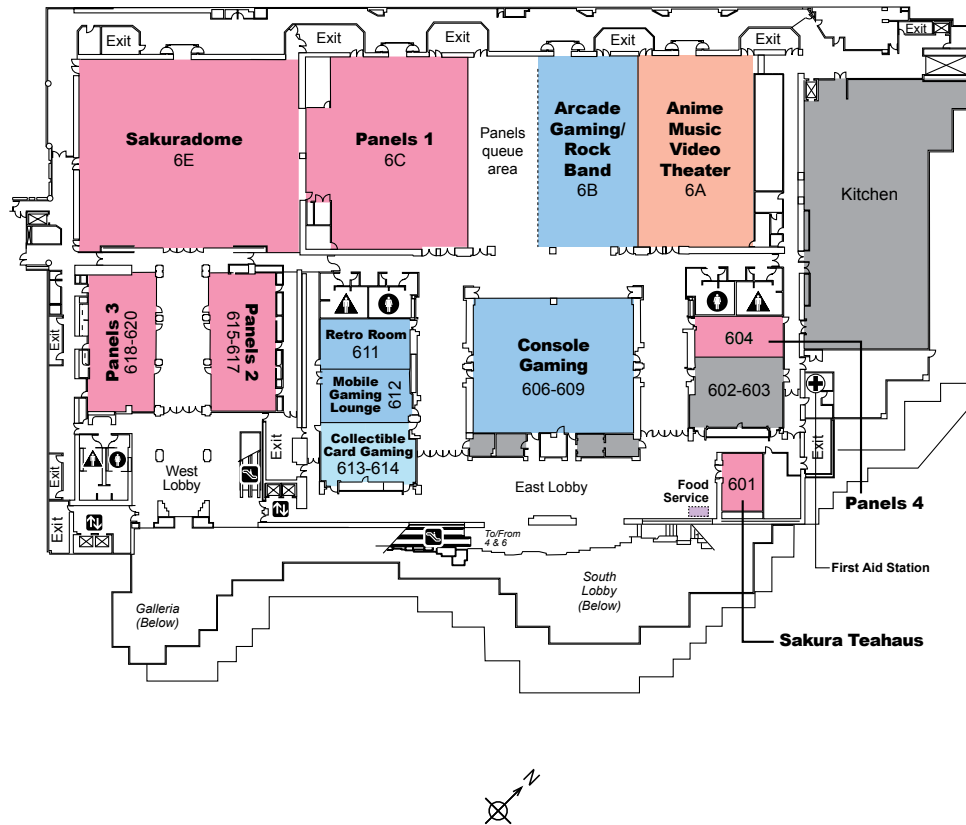

## Legend

<span style="display: inline-block; width: 15px; height: 15px; background-color: #ff99cc; border: 1px solid black;"></span> Event and Panel Rooms	<span style="display: inline-block; width: 15px; height: 15px; background-color: #99ccff; border: 1px solid black; text-align: center;">♂</span> Men's restrooms
<span style="display: inline-block; width: 15px; height: 15px; background-color: #ffcc99; border: 1px solid black;"></span> Video Theaters	<span style="display: inline-block; width: 15px; height: 15px; background-color: #ccffcc; border: 1px solid black; text-align: center;">♀</span> Women's restrooms
<span style="display: inline-block; width: 15px; height: 15px; background-color: #cc99ff; border: 1px solid black;"></span> Merchandise and Services	<span style="display: inline-block; width: 15px; height: 15px; background-color: #ffcc99; border: 1px solid black; text-align: center;">↕</span> Escalators to level above/below
<span style="display: inline-block; width: 15px; height: 15px; background-color: #ffcc99; border: 1px solid black;"></span> Workshops, Arts and Crafts	<span style="display: inline-block; width: 15px; height: 15px; background-color: #ffcc99; border: 1px solid black; text-align: center;">N</span> Elevators accessible by attendees
<span style="display: inline-block; width: 15px; height: 15px; background-color: #99ccff; border: 1px solid black;"></span> Video Gaming	<span style="display: inline-block; width: 15px; height: 15px; background-color: #ffcc99; border: 1px solid black; text-align: center;">☎</span> Pay phones
<span style="display: inline-block; width: 15px; height: 15px; background-color: #99ccff; border: 1px solid black;"></span> Tabletop Gaming	<span style="display: inline-block; width: 15px; height: 15px; background-color: #99ccff; border: 1px solid black; text-align: center;">+</span> First Aid Stations (Levels 4 & 6)
<span style="display: inline-block; width: 15px; height: 15px; background-color: #99ff99; border: 1px solid black;"></span> Sakura-Con offices	
<span style="display: inline-block; width: 15px; height: 15px; background-color: #999999; border: 1px solid black;"></span> Rooms not accessible by attendees	